



Pro 30 Plus Gas Caddy

Model FC-P30A-UL
Operator's Manual



Contents

| | Page |
|---------------------------------|-------------|
| Safety & Warning Instructions | 2 |
| General Product Description | 3 |
| Assembly | 3 |
| Operation | 3-4 |
| Storage | 4 |
| Product Specifications | 4 |
| Replacement Parts & Accessories | 5 |
| Troubleshooting | 6 |
| Notes | 7 |



JohnDow Industries, Inc.
151 Snyder Ave.
Barberton, OH 44203

REV 9/6/17

INSTRUCTIONS PERTAINING TO THE RISK OR INJURY TO PERSONS.

IMPORTANT SAFETY INSTRUCTIONS. SAVE THESE INSTRUCTIONS.



READ THIS MANUAL CAREFULLY BEFORE INSTALLING, OPERATING OR SERVICING THIS EQUIPMENT

It is the responsibility of the employer to place this information in the hands of the operator. Keep for future reference.

DANGER *Indicates an imminently hazardous situation which, if not avoided, will result in death or serious injury.*

1. Gasoline and other fuels are extremely flammable. Keep away from heat sparks and open flames as an explosion will result in severe personal injury.
2. Gasoline vapors can explode. Harmful or fatal if swallowed. Avoid breathing fuel vapors.
3. Attach ground wire and bond containers or equipment that are being pumped from and into to neutralize the potential charge between them
4. Ground all containers for extra safety by connecting the containers to a metal pipe or rod that is buried underground.
5. This product is an atmospheric tank. **DO NOT** modify this tank or its components. All components and design features have been tested and approved for use for handling flammable fuels.
6. **DO NOT** use funnels when transferring fuel through the fill tube.
7. Avoid excess agitation, shaking, splashing or high-flow rates as these can increase the risks of static charge build up.
8. **DO NOT** use electronics or mobile communication devices such as mobile phones while dispensing or handling fuel.
9. **DO NOT** smoke near or while using this gas caddy.
10. This product is intended for fuel transfer only and is **NOT** to be used to transport fuel in any vehicle or trailer.

WARNING *Indicates a potentially hazardous situation which, if not avoided, may result in death or serious injury.*

1. **DO NOT** exceed 50 psi air pressure.
2. Obtain Material Safety Data Sheets on fuels being handled. Always wear required proper personal protection equipment and clothing.
3. **DO NOT** tip or operate on incline surfaces.
4. Keep both hands on the handles when maneuvering to maintain control.
5. When using this product precautions should always be followed, including the following:
 - a. Read all instructions before using this product.
 - b. To reduce the risk of injury, close supervision is necessary.
 - c. Keep out of reach of children.
 - d. **DO NOT** put fingers or hands into openings or into the pump.
6. Ensure that all fittings and threaded hose and pipe connections are tightened and leak free.

CAUTION *Indicates a potentially hazardous situation which if not, avoided, may result in minor or moderate personal injury. It may also warn of unsafe practices.*

1. Be certain all operators of the equipment have been trained for safe working practices and understand its limitations.
2. Use Caddy for "one type of fuel ONLY" to avoid possible damage to vehicle.
3. Use care when maneuvering to prevent injury or loss of control. Seek assistance to avoid strain or injury when required.
4. Not for prolonged storage of fuel.
5. Monitor flow rate and fill levels to prevent overflows and spills. **DO NOT** overfill containers, drums or tanks.
6. Always empty the pump and hose after use by lifting the hose and turning the handle in the opposite direction of the arrow to empty all remaining liquids back into the caddy.

GENERAL PRODUCT DESCRIPTION

The Gas Caddy is designed and approved to safely transfer fuel to and from a vehicle. It may be used to safely store fuel during vehicle service. It is approved for use with unleaded gasoline, diesel, and kerosene fuels.

The FC-P30A comes standard with a 10 micron filter for use with gasoline. Other filters are available for other fuels. Select the correct filter for the intended application. Proper filter selection is critical to achieving maximum pumping efficiency and to properly remove contaminants from the fuel.

Refer to the table shown in REPLACEMENT PARTS AND ACCESSORIES if you intend to pump different fuels.

| Fuel Type | Filter Type |
|---------------------|-------------|
| Unleaded Gasoline | 10 micron |
| Diesel and Kerosene | 30 micron |

ASSEMBLY

Tools and Supplies (not included):

- TPE tape
- 1-1/16 inch open end wrench
- 1/4" NTP Quick-connect fitting to connect to shop air.

1. Wrap 2 inch NPT thread on fill tube 4-6 wraps with PTFE tape wrapping clockwise.
2. Install quick-connect air fitting into air throttle valve.
3. Assemble the discharge hose threading the 3/4 NPT fitting into 90° fitting located on the front of the valve assembly. Tighten with wrench.
4. Coil and hang the discharge hose on the hose hanger bracket on the side of the tank.
5. Thread the 2 inch fill pipe and cap assembly onto the fitting in the center of the tank. Tighten by hand until secure.
6. Remove tape from top of fuel gauge and install plastic indicator cap and plastic nut onto float assembly. Align indicator mark to point diagonally across tank so that float is free to move full range. Tighten nut by hand to secure cap and fuel gage.

NOTE: The regulator is factory preset to 40 psi (2.75 BAR). Adjust if desired to increase or decrease flow rate. Do not set regulator above 50 psi (3.45 BAR). This will not increase flow and result in premature wear of air motor and/or pump.

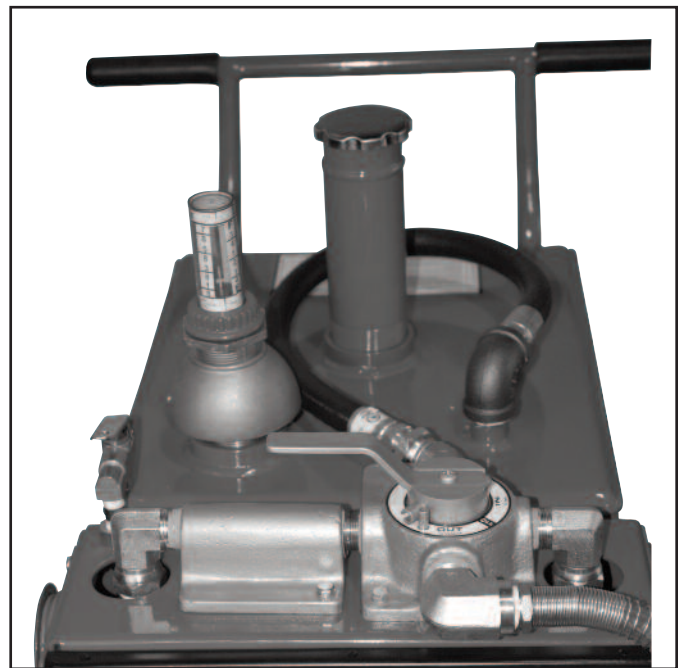
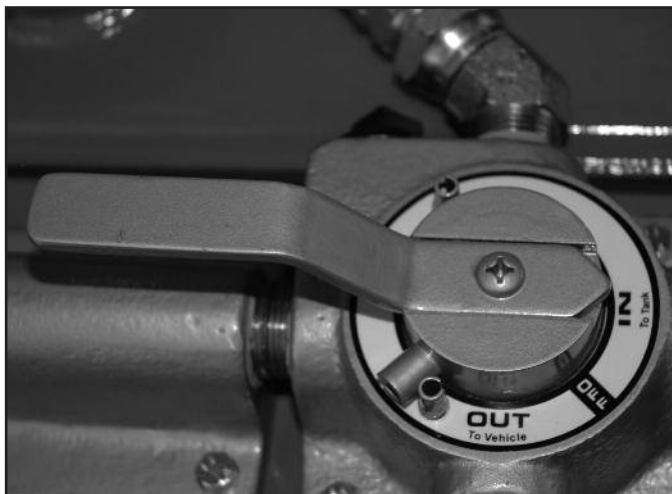

Fig. 1

OPERATION

PUMPING FROM VEHICLE TO GAS CADDY

1. Position the Gas Caddy near the vehicle and lock the wheel brakes.
2. Attach the ground wire clamp to the vehicle to a known ground surface.
3. Place the hose inside the fill pipe of the vehicle fuel tank.
4. Align valve handle so that the point is to the "IN" to tank position. See Figure 2.
5. Connect shop air supply. **WARNING: AIR SUPPLY MUST NOT EXCEED 120 PSI.**
6. Squeeze the air throttle valve to operate pump. Closely monitor flow to prevent overfilling.
7. Release valve when desired amount is pumped.
8. Uncoil and raise the hose and briefly run the pump to return any remaining fuel in the system to the tank.
9. Coil and hang the hose on the hanger bracket.
10. Turn valve handle to the "OFF" position.

Fig. 2

OPERATION

PUMPING FROM GAS CADDY TO VEHICLE

1. Position the Gas Caddy near the vehicle and lock the wheel brakes.
2. Attach the ground wire clamp to the vehicle to a known ground surface.
3. Place the hose inside the fill pipe of the vehicle fuel tank.
4. Align valve handle so that the point is position to the "OUT" to vehicle position. (See Fig. 3)
5. Connect shop air supply. **WARNING: AIR SUPPLY MUST NOT EXCEED 120 PSI.**
6. Squeeze the air throttle valve to operate pump. Closely monitor flow to prevent overfilling or spilling.
7. Release valve when desired amount is pumped.
8. Turn the valve to the "IN" to tank position.
9. Uncoil and raise the hose and briefly run the pump to return any remaining fuel in the system to the tank.
10. Coil and hang the hose on the hanger bracket.
11. Turn valve handle to the "OFF" position.

STORAGE

1. Disconnect supply air when not in use.
2. Always place the valve in the "OFF" position when not in use.
3. Wrap and store the hose on the provided hose wrap bracket.
4. Wrap and store the ground wire on the provided wire wrap bracket.
5. Locate the park the Gas Caddy on a flat level surface, away from any potential ignition sources, away from any potential hazards that may impact or damage the Gas Caddy.
6. Lock wheel brakes.
7. Be certain that the fuel gage vent dome, indicator cap, fill tube and fill tube cap are all present and secure. Replace any missing parts immediately.

PRODUCT SPECIFICATIONS

| | |
|-----------------|--------------------------|
| Weight (empty): | 154 lbs (69.5 kgs.) |
| Capacity: | 30 gal (114 L) |
| Length: | 31.25" (76 cm) |
| Width: | 25.0" (88.9 cm) |
| Height: | 39.50" (100.5 cm) |
| Approx. Flow: | 7 gpm (26 L pm) @ 40 PSI |

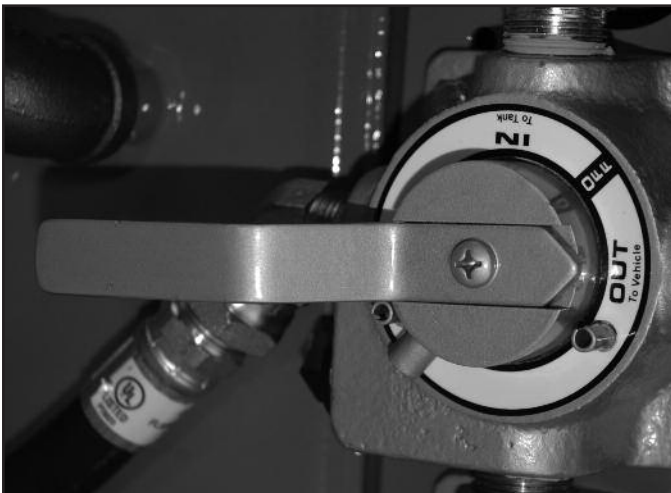
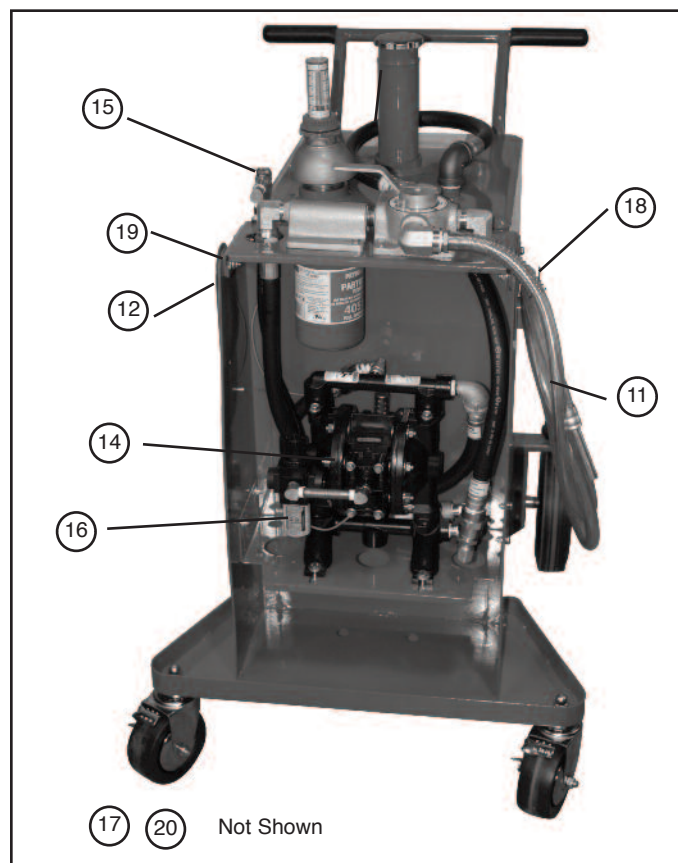
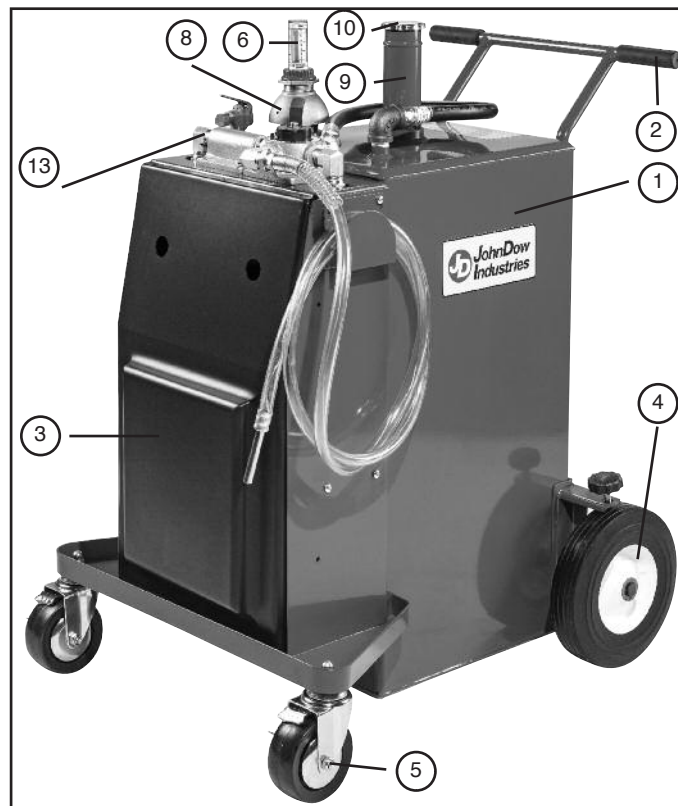

Fig. 3

Replacement Parts & Accessories

REPLACEMENT PARTS:

| Item | Description | Qty | Part No. |
|------|-----------------------------------|-----|--------------|
| 1 | Tank | 1 | _____ |
| 2 | Handle | 1 | 30GC-02C |
| 3 | Cover | 1 | 30GC-49-UL |
| 4 | Wheel (10") | 2 | 30GC-UL |
| 5 | Caster (5") | 2 | 30GC-48 |
| 6 | Fuel Gage (cap/nut) | 1 | 30GC-FGK |
| 7 | Fuel Gage (complete) | 1 | FC-P30-FG |
| 8 | Vent | 1 | 30GC-08-VENT |
| 9 | Fill Tube | 1 | 30GC-09-01 |
| 10 | Fill Cap | 1 | 30GC-09-02 |
| 11 | Hose Assembly | 1 | 80-593-NI |
| 12 | Ground Strap | 1 | 80-572 |
| 13 | Valve/Filter Support Asm. | 1 | 30GC-30/31 |
| 14 | ARO Diaphragm Pump (UL Listed) | 1 | 670042 |
| 15 | Air Throttle Valve | 1 | FC-AT |
| 16 | Filter/Regulator | 1 | P391246000 |
| 17 | Contents Decal Set | 1 | 25GC-04 |
| 18 | Hose Bracket | 1 | 30GC-46 |
| 19 | Ground Wire Bracket | 1 | 30GC-47 |
| 20 | Hose Kit (3 Hoses) | 1 | FC-P30A-HK |



REPLACEMENT FILTERS

| Fuel Type | Filter Type | Part No. |
|-------------------|-------------|----------|
| Unleaded Gasoline | 10 micron | 10M-FF |
| Diesel/Kerosene | 30 micron | 30M-FF |

Note: Coat the O-ring seal with oil or grease before assembly. Hand tighten by turning approximately 1/2 turn after rubber seal contacts the filter support. Do not over-tighten.

TROUBLESHOOTING

| CONDITION | POSSIBLE CAUSE | SOLUTION |
|--|---|---|
| Poor flow | Filter is incorrect size for type of fuel | Replace with correct size filter 1 micron for E85. 10 micron for gasoline, 30 micron for diesel/kerosene |
| | Filter is clogged | Replace filter |
| | Low air pressure | Check incoming supply air pressure. Check regulator setting and adjust to 40 - 50 psi. Check for tube connection and fittings. |
| Pump is difficult to prime | Hose not submerged in fuel when trying to prime | Check hose and reposition hose in vehicle fuel tank |
| | Loose filter | Inspect and tighten |
| | Leak at fittings or pump mount | Check fittings and tighten as required. |
| | Leak in hose fittings | Check fittings and tighten |
| | Damaged, kinked, or cracked hose | Replace with hose assembly |
| Fuel level gauge does not work | Float positioned diagonally across tank | Remove red plastic nut and indicator cap. Remove float mechanism and position so that float is position across tank. Replace cap and nut. |
| Ground wire is damaged or will not clamp | Damaged | Replace |

**For Service Assistance
Phone Toll Free 1-800-433-0708**